

ROMAN AND WOVEN WOOD SHADES

Roller Lift System Continuous Cord Loop

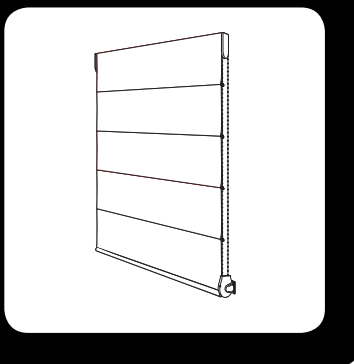

3DAYBLINDS™
YOU'LL LOVE THE TREATMENT

GETTING STARTED

A few simple tools are required:



Steel Tape Measure



Pencil

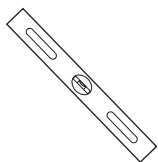

Level
(for outside mount)



Power Drill and
Drill Bits



Flathead & Phillips
Screwdriver



Awl (or tool for
starting a screw hole)

Included in your order is all the hardware necessary for a normal installation. Depending on the mounting surface, fasteners other than the screws provided may be required. Wall board and plaster require the use of anchors such as expansion or toggle bolts. Bricks, tile and stone need special plugs and drill bits. Wood should always be pre-drilled to avoid splitting.

Professional installation is also available in most areas, call 800-800-3329.

STANDARD HARDWARE

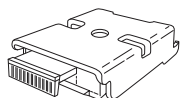

Inside Mount Bracket

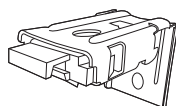

Outside Mount Bracket

OPTIONAL HARDWARE

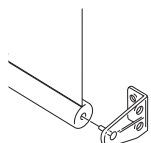

Hold Down Bracket

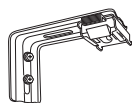

Extension Bracket



Spacers

BRACKET INFORMATION

The brackets you received with your product are **REQUIRED** for proper installation. Brackets should be installed at each end and any additional brackets will need to be evenly spaced between the two end brackets.

INSIDE MOUNT

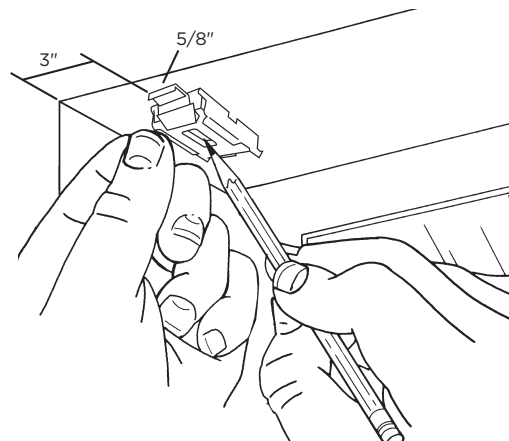

- Brackets should be installed 3" in from each corner of the window and 5/8" back from the front edge of the window casing.
- Additional brackets, if included, are **REQUIRED** for proper installation and should be installed evenly spaced between the two end brackets.
- Proceed to "Shade Installation".

OUTSIDE MOUNT

NOTE: You will be using your shade with mounting brackets attached to the headrail to mark the position of the brackets on your wall or molding.

- Attach brackets to the headrail. Additional brackets, if included, are REQUIRED for proper installation and should be spaced evenly over the width of the headrail. Lower the shade to it's full length. (See "Shade Operation".)

NOTE: Using extension brackets, attach mounting brackets to extension brackets with nuts and bolts before attaching brackets to headrail. (See "Optional Accessories".)

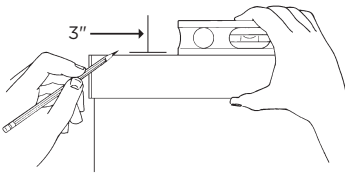

- Hold the shade up to the desired mounting position over the window. Once the shade is level, mark the wall or molding on either side and top of each mounting bracket.

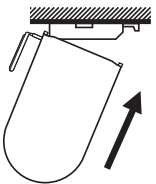

- Remove the mounting brackets from the headrail by pushing the plastic release button on each bracket.

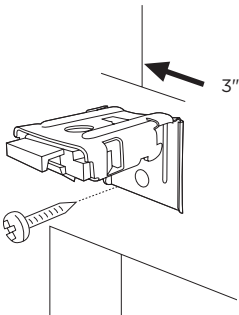

- Fasten brackets to wall where marked $1\frac{1}{2}$ " of the flat mounting surface is required to mount your shade.

END MOUNT

An end mount is recommended for shades being installed with an arch top or for inside mount applications where there is no alternative mounting surface.

NOTE: You will be using your shade with mounting brackets attached to the headrail to mark the position of the brackets in your window opening.

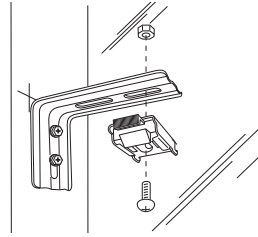

- Attach the mounting brackets to each extension bracket using the holes indicated in the diagram. Attach brackets to the headrail 3" from wall. Lower the shade to it's full length. (See "Shade Operation".)

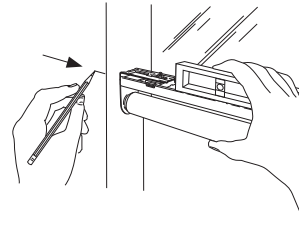

- With the mounting brackets attached, hold the shade up to the desired mounting position inside the window casing.

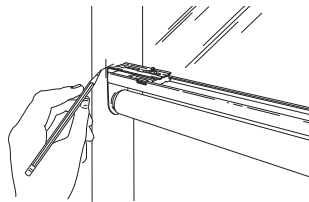

- Once the shade is level, recess the shade $\frac{1}{4}$ " from the front edge of the window casing and mark the wall on the front side and top edge of each extension bracket.

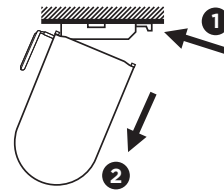

- Remove the mounting brackets from the headrail by pushing the plastic release button on each bracket.

NOTE: Diagram does not show extension bracket.

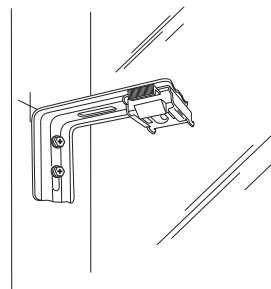

- Install an assembled end mounting bracket at each set of marks in your window opening.

SHADE INSTALLATION

NOTE: Shade installation is much more easier and safer with two people.

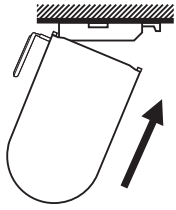

- Place the back of the headrail onto the back hook of the bracket.

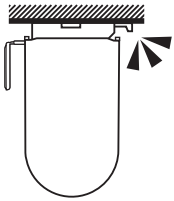

- Rotate the headrail up and snap into place.

NOTE: Shade must be installed level for fabric to roll evenly when raised and lowered

SHADE OPERATION

- To raise the shade pull on the outside portion of the cord loop chain.
- To lower the shade pull, pull on the inside portion of the cord loop chain.

SHADE REMOVAL

NOTE: Window covering removal is much easier and safer with two people.

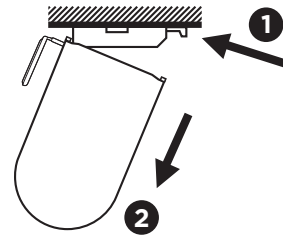

- Raise the shade completely.
- Locate the plastic release button on each bracket.
- Starting at one end of the shade, push the release buttons to unlock the headrail from the bracket.
- Repeat for all brackets until the shade is free from all brackets.

TENSIONER INSTALLATION

IMPORTANT! The shade will not fully function until device is installed.

MOUNTING BRACKETS

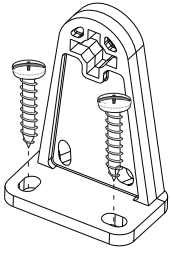

Option A

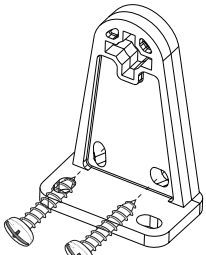

Option B

- Determine which direction the mounting bracket will face relative to the Tension Device. Make sure the Tension Device will be snapped into the mounting stand in the same correct direction.
- Before attaching Tension Device to the base, measure and mark the location in the window where the tension device will be mounted.
- Mount the base in position without the tension device attached.
- Position the Tension Device on the window frame or the wall so that the Tension Device and control cord/chain does not interfere with raising or lowering the shade.

IMPORTANT! The Tension Device should be installed so the cord/bead chain is taut, but not tight, without stretching or pulling down on it. Stretching the cord/bead chain will cause excessive wear. Do not twist or cross the control cord/bead chain.

- Holding the Tension Device upright, and in position, as shown, insert and secure the two screws through holes in the mounting bracket.
- The mounting screws must be secured into a solid surface or use molly bolts.
- On inside mount shades the Tension Device may be mounted to the window sill, or side window frame or when the treatment spans beyond the window frame it may be mounted to the wall.

MOUNTING TENSION DEVICE TO MOUNTING BRACKET

NOTE: Once the tension device is snapped to the base it is designed not to be removed. **See WARNING on page 5.**

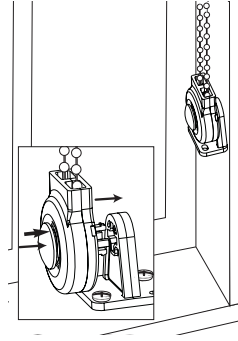

- Press center round button exposing the four latching legs and press into the corresponding thru-hole of the mounting bracket stand until they latch snap and lock to the mounting stand.

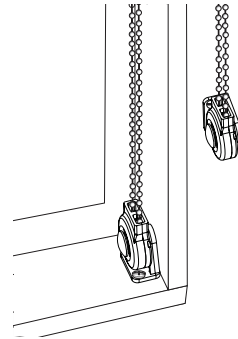

- The loop should now pass freely through the Tension Device.

OPTIONAL ACCESSORIES ROMAN SHADE ONLY

HOLD DOWN BRACKETS

Hold down brackets are used primarily on shades mounted to doors or in motor homes. There are two small holes in the end caps that are covered by a thin plastic layer. Use the pin on the hold down bracket to push through the center of the end cap and it will break through the plastic layer.

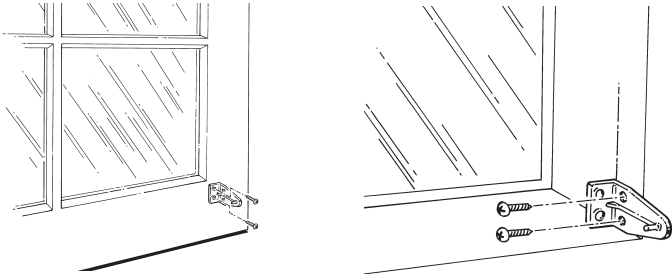

- With the shade lowered to its full length, place the pin of each hold down bracket into the hole in each end of the bottom rail.
- Mark the mounting surface, either to the side or back of the window frame, through the holes in the hold down bracket. Make sure the hold down brackets are level and aligned with each other.
- Raise the shade and screw the hold down brackets into the mounting surface using the screws provided.

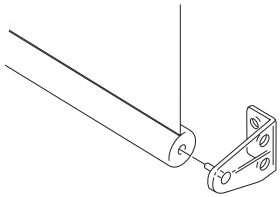

- Lower the shade and flex the hold down bracket outward so that the pin can be inserted into the hole in the end cap.



WARNING

Young children can STRANGLE in cord and bead chain loops and in the loop(s) above the cord connector. They can also wrap cords around their necks and STRANGLE.

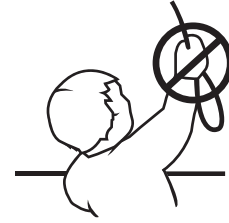

- Always keep cords and bead chains out of children's reach.
- Move cribs, playpens, and other furniture away from cords and bead chains. Children can climb furniture to get to cords.



3DAYBLINDS™
YOU'LL LOVE THE TREATMENT
800-800-3329 | 3dayblinds.com